

# Health Care Provider Quick Start Guide

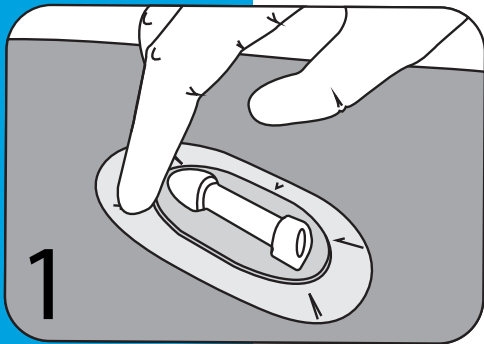

Control wrinkles when applying over the wound.

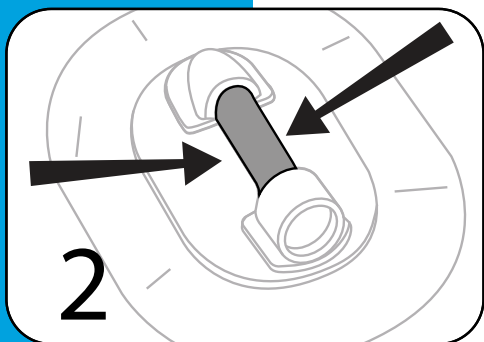

**Pinch the middle of the pump** with your thumb and one finger.

**DO NOT** pinch the ends of the pump.

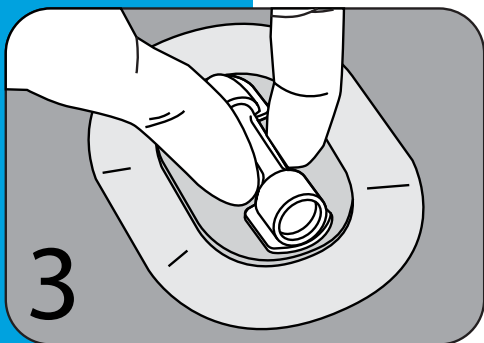

Pinch about **10-12 times** until the pump walls remain touching at the middle.

**DO NOT** flatten entire pinch area.

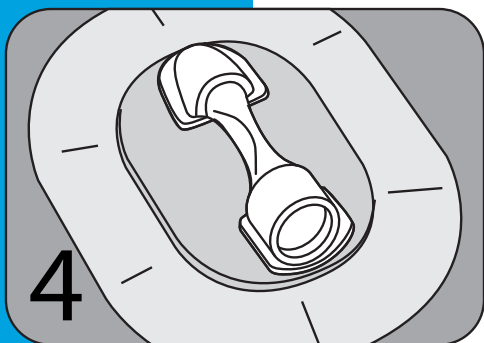

The system is working properly if the pump walls remain touching at the middle.

Intended for 3 days of use.